

TERMINAL BLOCK SERIES

固定式端子台

SPECIFICATION 規格

Specification 規格	IN12BK	IN13BK	IN23BK	IN33BK	IN41BK
Current 電流	10A	10A	20A	30A	40A
Voltage 電壓	600V				
Cross-Section 截面	1.6mm ²	1.6mm ²	3.5mm ²	8mm ²	14mm ²
Clamping Screw 鎖緊螺絲	M3.5	M3.5	M4	M5	M5
Pole 極	2	3	3	3	1
Insulated Materials 絕緣材料	PC(PA66)				
Operating Temperature (°C) 操作溫度 (5°C)	-40°C + 110°C (max +220°C)				
Conductor 導體	Copper, Nickel Plated 黃銅, 電鍍鎳				

IN12BK

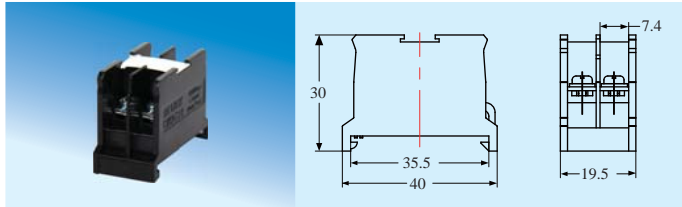

IN12C

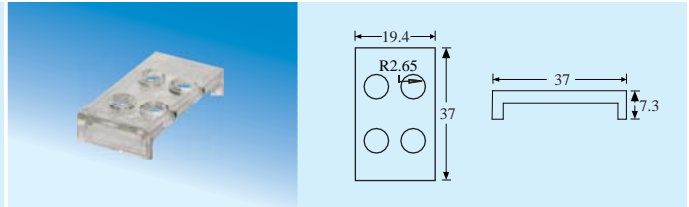

IN13BK

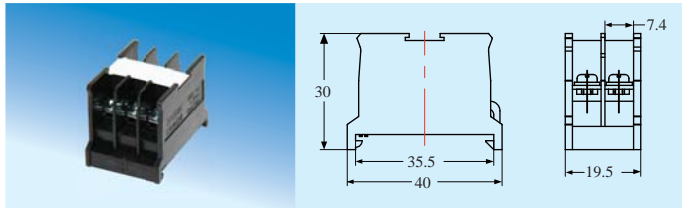

IN13C

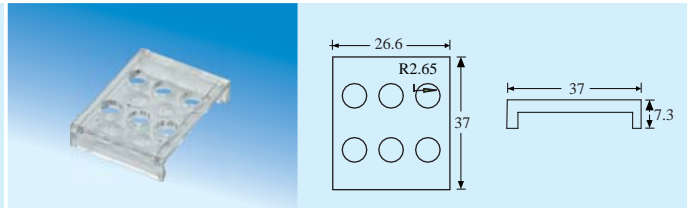

IN23BK

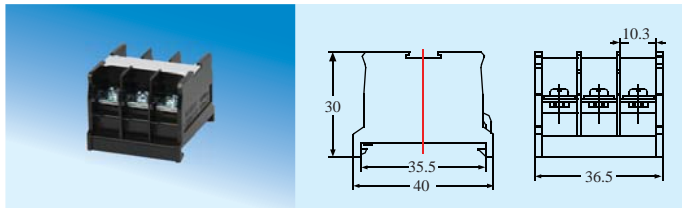

IN23C

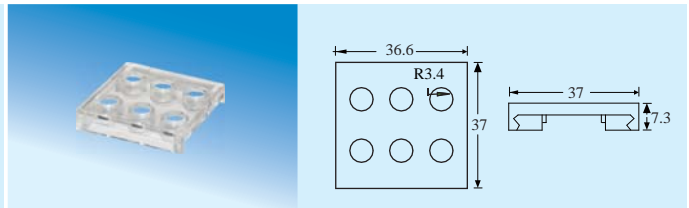

IN33BK

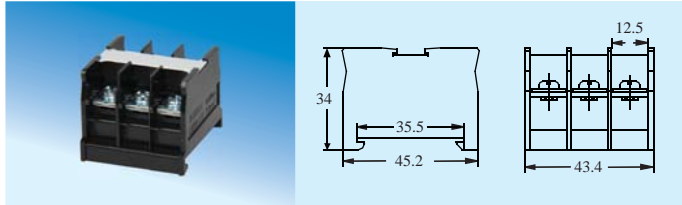

IN33C

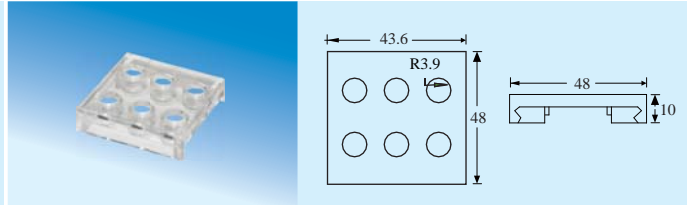

IN41BK

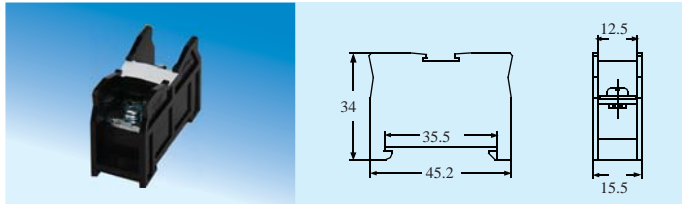

IN41C

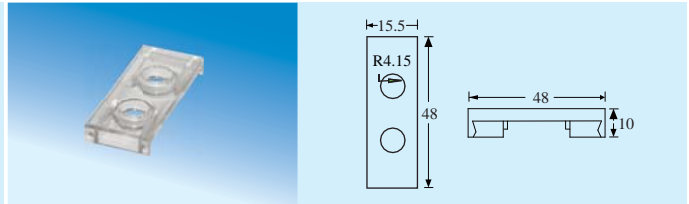

TERMINAL BLOCK SERIES 固定式端子台

SPECIFICATION 規格

Specification 規格	IN61BK	IN101BK	IN201BK	IN401BK
Current 電流	60A	100A	200A	400A
Voltage 電壓	600V			
Cross-Section 截面	22mm ²	38mm ²	100mm ²	200mm ²
Clamping Screw 鎖緊螺絲	M6	M8	M10	M12
Pole 極	1	1	1	1
Insulated Materials 絕緣材料	PC(PA66)			
Operating Temperature (°C) 操作溫度 (5°C)	-40°C + 110°C (max +220°C)			
Conductor 導體	Copper, Nickel Plated 黃銅, 電鍍鎳			

IN61BK

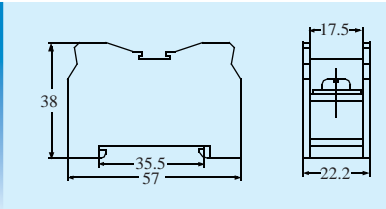

IN61C

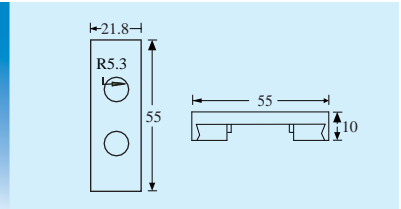
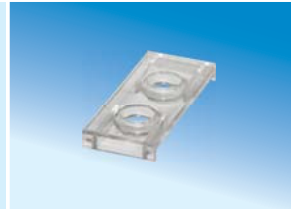

IN101BK

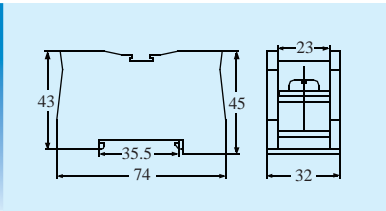

IN101C

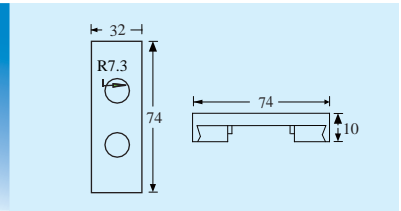

IN201BK

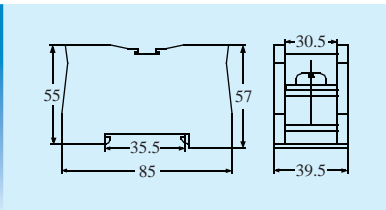

IN201C

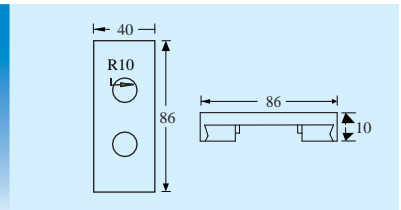

IN401BK

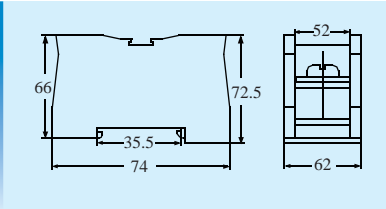

IN401C

